

installation for 2.0 / 4.0

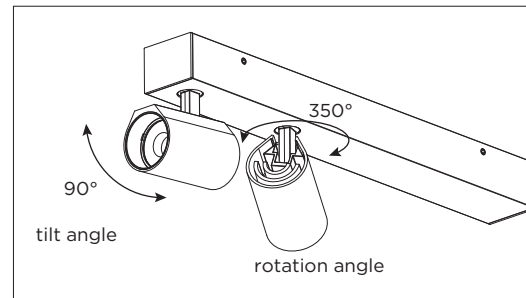

DIMENSIONS

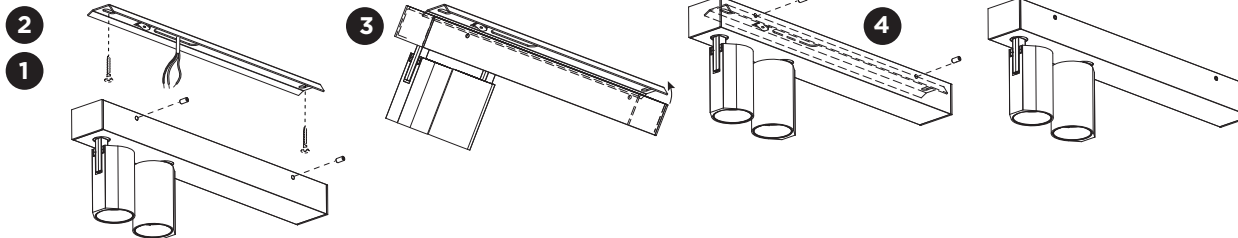
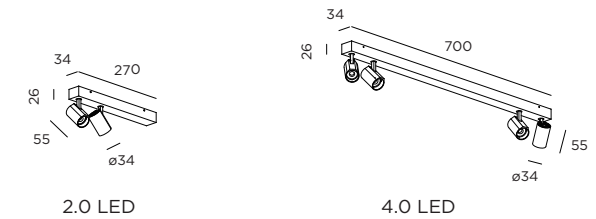

MOUNTING INSTRUCTION

1 Remove the mounting base from the luminaire by loosening the socket screws and mount it on the ceiling with screws (screws are not included).

2 POWER CONNECTION
Connect to 220-240V.

Connect the ceiling base earth cable.

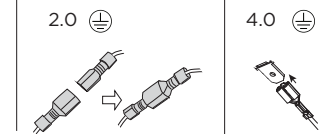
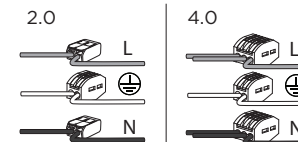

3 Attach the luminaire to the mounting base with the screw opposite side first and tilt towards the ceiling as shown.

4 Fixate the luminaire on the base with the socket screws.



- Only to be installed outside arms reach.
- The LED chip of this luminaire is not replaceable; when the LED chip reached its end of life the whole luminaire shall be replaced.

Mounting base:

front view

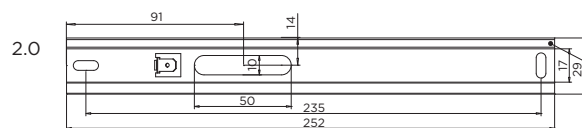

side view



The screws are on the upper side.

4.0

front view

